

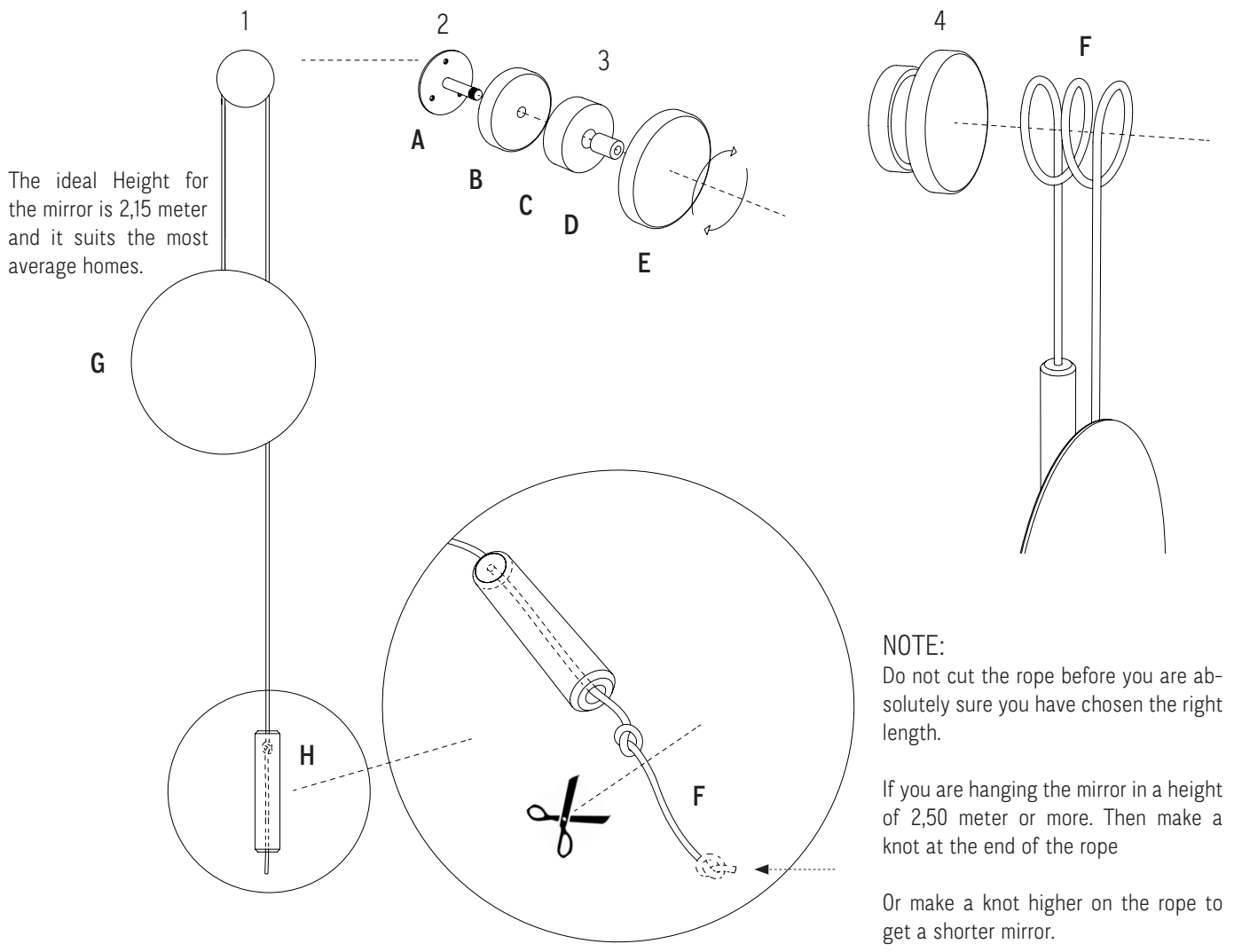

RISE & SHINE WALL MIRROR

USER INSTRUCTIONS



ASSEMBLING:

Please follow the instructions carefully when assembling the Rise & Shine Wall Mirror.

1. Unpack all parts to make sure nothing is missing. The included wall plugs and screws may only be used for brick and Concrete walls. Contact your local hardware store for guidance.
2. Mount the Wall Fitting (A) on the wall (Recommended height is 2,15 meter from the center of the wall Fitting and down to the floor)
3. Slide the middle parts (B/C/D) on the thread and lock it by screwing the wooden front piece (E)
4. Make Sure to be Two people when hanging up the mirror, one holding the Mirror (G) and one the Weight (H) while turning the rope (F) three times around the wheel - Make sure the Brass/Metal weight is hanging closest to the wall.

CONTENTS:

- A - Wall Fitting
- B - Wooden Back Piece
- C - Nylon Wheel
- D - Inner tube
- E - Wooden Front
- F - Rope
- G - Mirror
- H - Brass/Steel Weight



RISE & SHINE WALL MIRROR

WE HOPE YOU WILL ENJOY YOUR NEW WORKS PRODUCT

The Rise & Shine Wall Mirror is carefully crafted, and every item is unique. Smaller marks or minor deviations in the material and surface may occur.

SAFETY PRECAUTIONS/ ATTENTION

Please read the instructions carefully and keep this sheet for future reference. New Works Aps is not responsible for any faults or damages caused by not following the instructions correctly. Do NOT modify the product in any way.

Keep the product and packaging out of reach of children. Dispose of waste packaging according to local regulations.

In rare cases, a damaged edge or scratched surface can cause the mirror to suddenly crack into small pieces. Such crack may cause sharp fragments, however, this is extremely rare. Avoid collisions from the side – this is where the glass is most vulnerable.

The Rise & Shine Wall Mirror is intended for indoor use only.

CLEANING INSTRUCTIONS/ MAINTANCE & CARE

Wipe the surface with a soft cloth, either dry or slightly damp. Do not use abrasive cleaning tools or strong cleaning agents such as household glass cleaner, white spirit, or turpentine.

For more information, such as product overview, material description and disclaimers - please visit our website at www.newworks.dk for further information. If you have any questions or comments, please do not hesitate to contact us at info@newworks.dk.



NEW WORKS
OBJECTS OF COPENHAGEN

NEW WORKS
VED VESTERPORT 6
1612 COPENHAGEN
DENMARK

NEWWORKS.DK
INFO@NEWWORKS.DK