

# PANTOP Ø23 PENDANT

## Assembly Instruction



## Before you get started



Read the entire manual  
before mounting



Set aside plenty of time

**Cleaning:** Turn off the electricity. Wipe off dust with a dry, soft cloth. If needed, clean with a soft cloth dampened in lukewarm water with a mild detergent without abrasives, solvents, alcohol or acid. Water must have evaporated before the lamp is switched on again.

**Safety:** Turn off the electric current before mounting. Consult a qualified electrician if in any doubt. Indoor use only. If the external flexible cable or cord of this luminaire is damaged, it shall be replaced by the manufacturer's service agent or a qualified person.

**Light source recommendation:** LED, E14, 2700K, max. 25W, max. Ø8cm, CRI90+. For optimal brightness choose a light source with corresponding lumen output: for kitchen light: 500-800, and for atmospheric light choose 300-500 lumens.

**Box contains:**

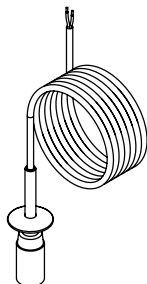

1.

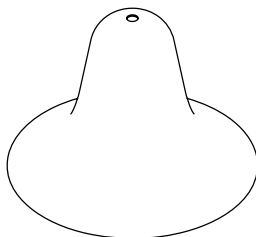

2.



3.

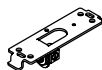

4.



5.

**You will also need:**

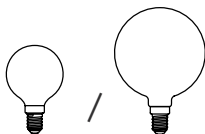

E14, max. 25W



Flathead  
Screwdriver

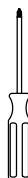

Philips  
Screwdriver



Screws and rawlplugs  
suitable for the  
particular ceiling

1

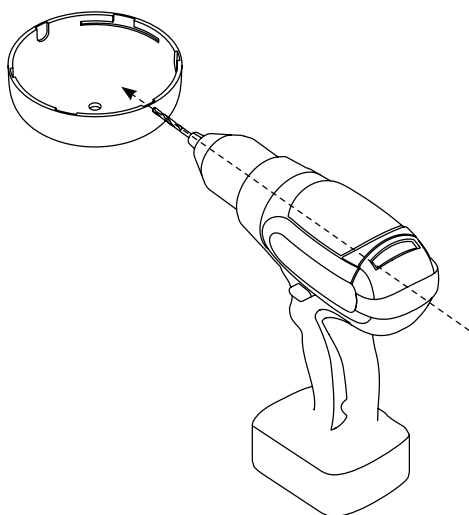

2

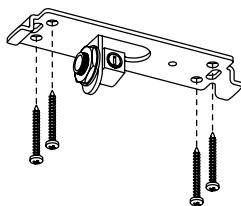

4

3

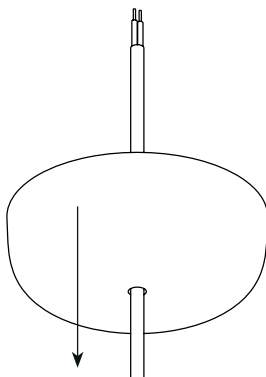

4

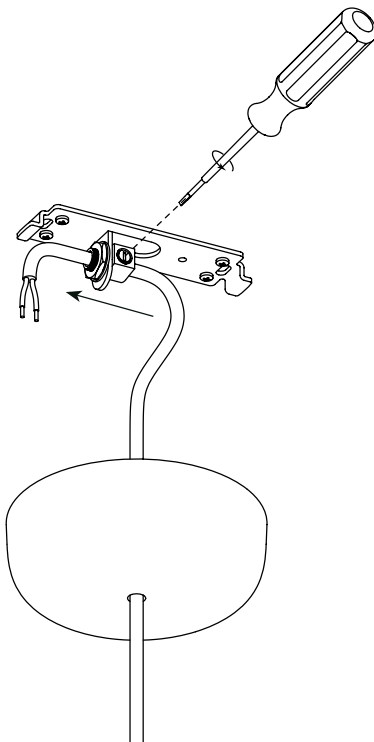

5

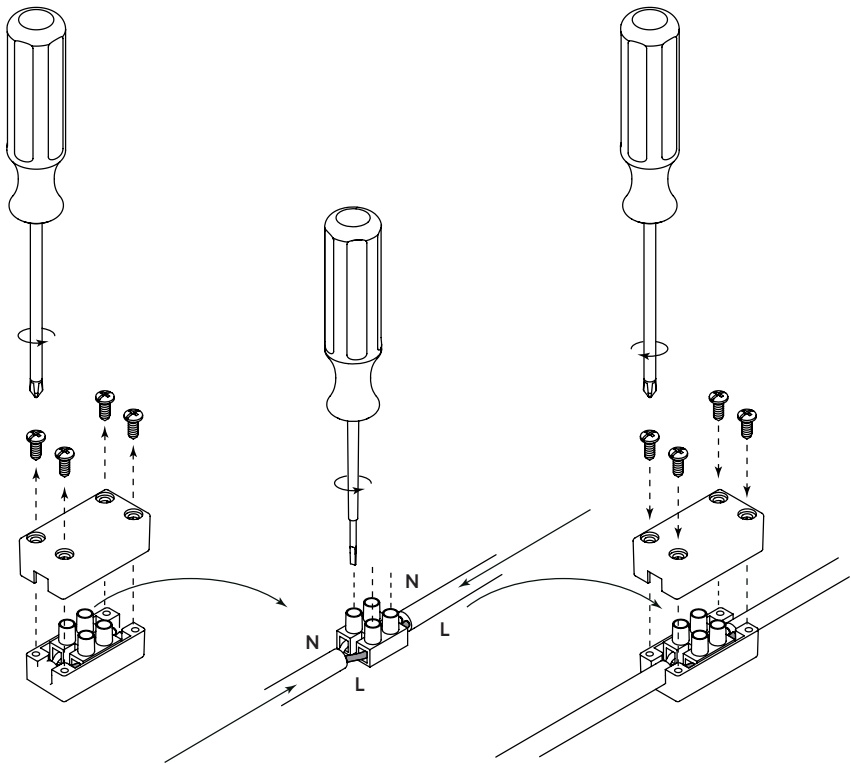
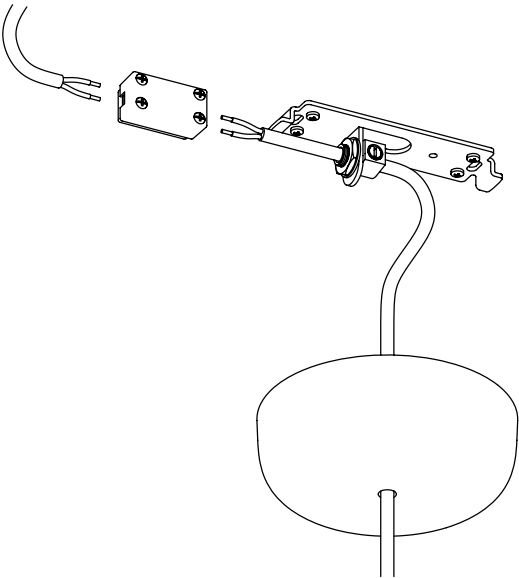

6

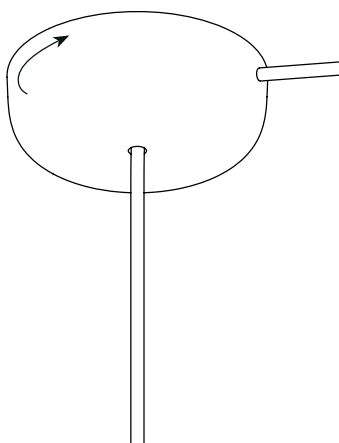
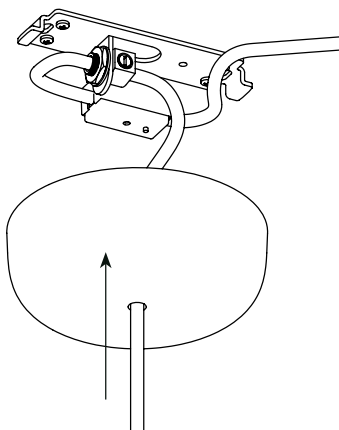

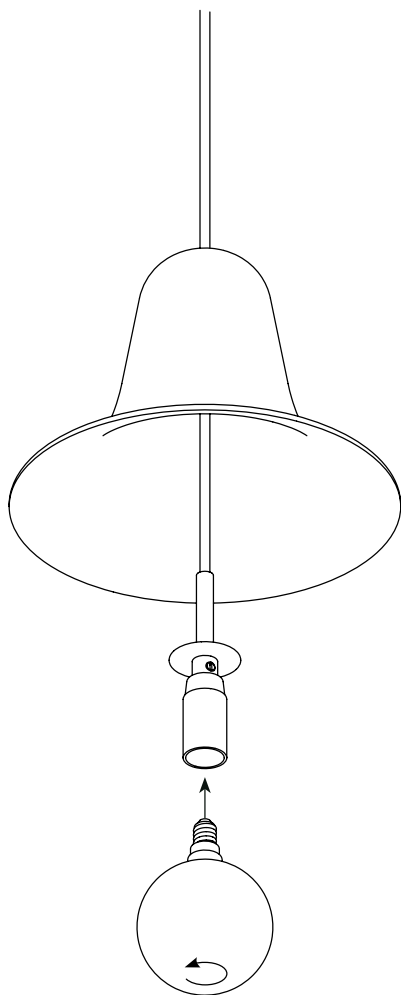



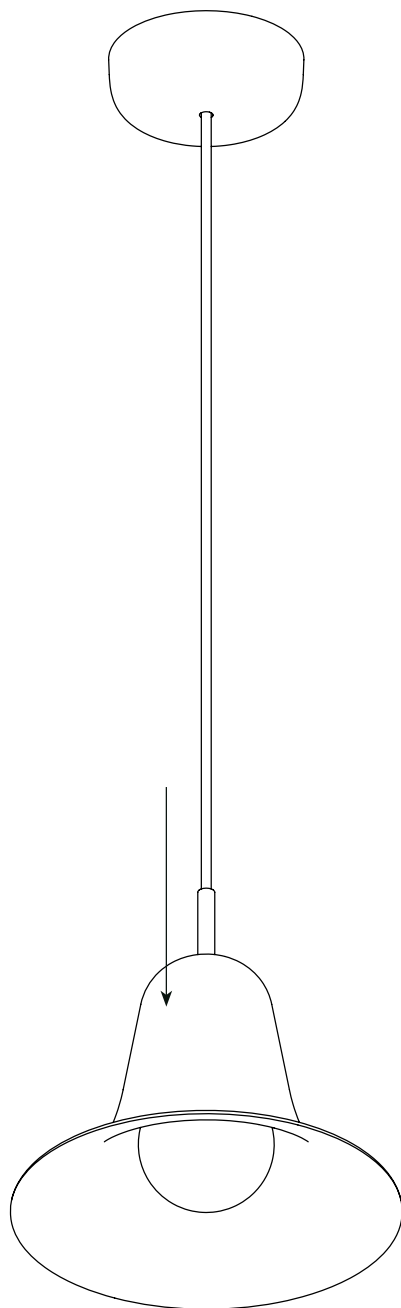



Egeskovvej 29 | 8700 Horsens | Denmark  
info@verpan.com | verpan.com

Supplier fsc  
logo is placed  
here. Black  
with no  
background  
width: 17mm